

人吉市（宅地） 埋設物試掘調査概要図

調査箇所：熊本県人吉市上田代町字大原 2038番2

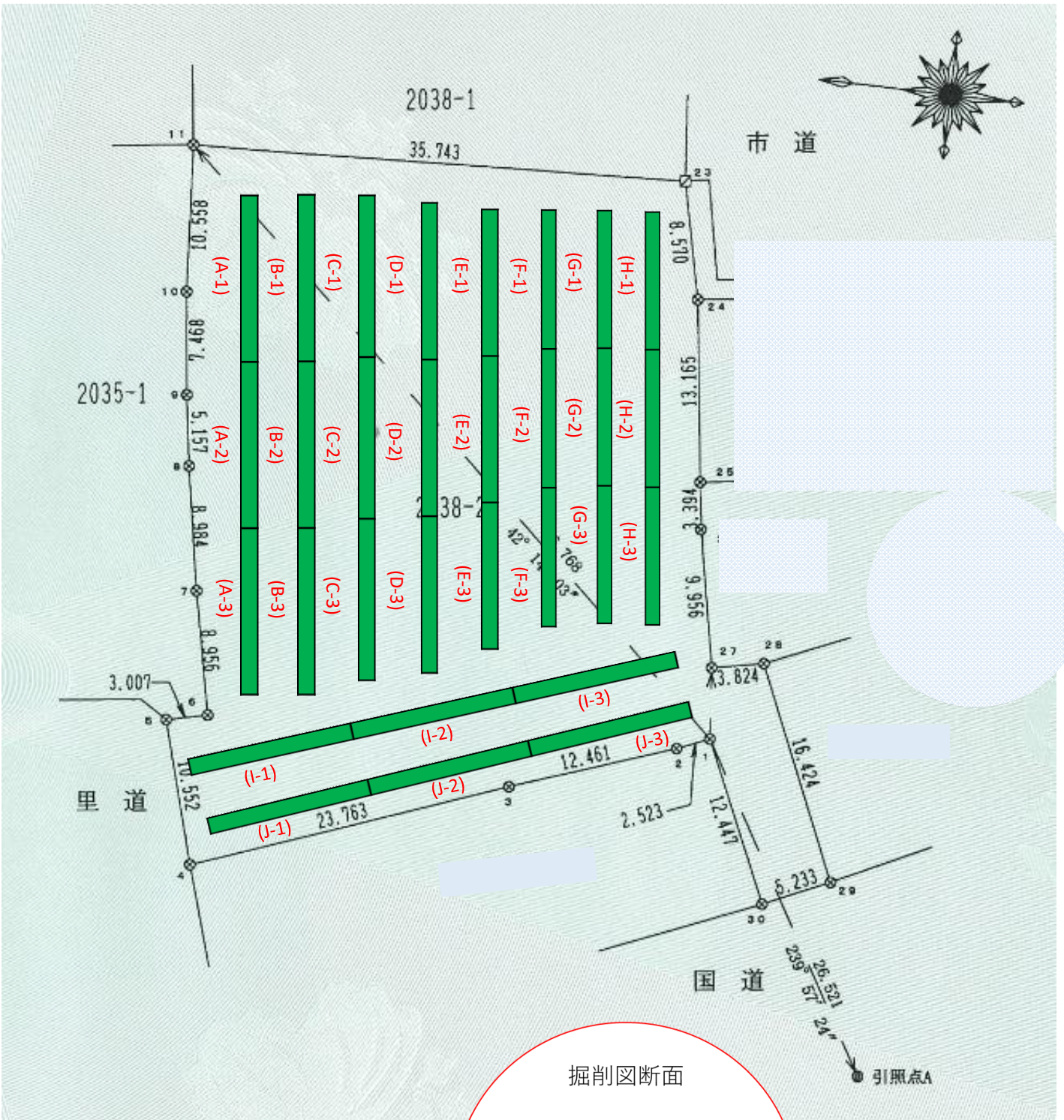

掘削図断面

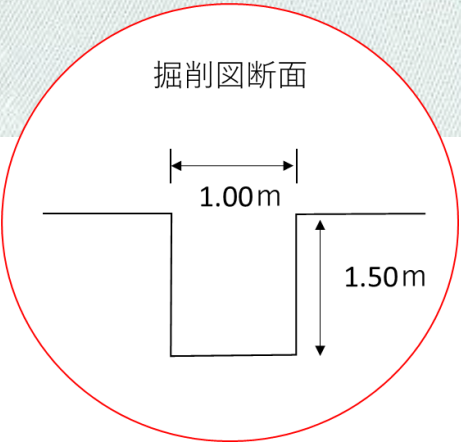

埋設物試掘調査内訳

	長さ(m)		掘削幅(m)		掘削面積(m ²)		深さ(m)		掘削容積(m ³)
A-1	12.00	×	1.00	=	12.00	×	1.50	=	18.00
A-2	12.00	×	1.00	=	12.00	×	1.50	=	18.00
A-3	12.00	×	1.00	=	12.00	×	1.50	=	18.00
B-1	12.00	×	1.00	=	12.00	×	1.50	=	18.00
B-2	12.00	×	1.00	=	12.00	×	1.50	=	18.00
B-3	12.00	×	1.00	=	12.00	×	1.50	=	18.00
C-1	12.00	×	1.00	=	12.00	×	1.50	=	18.00
C-2	12.00	×	1.00	=	12.00	×	1.50	=	18.00
C-3	12.00	×	1.00	=	12.00	×	1.50	=	18.00
D-1	11.00	×	1.00	=	11.00	×	1.50	=	16.50
D-2	11.00	×	1.00	=	11.00	×	1.50	=	16.50
D-3	11.00	×	1.00	=	11.00	×	1.50	=	16.50
E-1	11.00	×	1.00	=	11.00	×	1.50	=	16.50
E-2	11.00	×	1.00	=	11.00	×	1.50	=	16.50
E-3	11.00	×	1.00	=	11.00	×	1.50	=	16.50
F-1	10.00	×	1.00	=	10.00	×	1.50	=	15.00
F-2	10.00	×	1.00	=	10.00	×	1.50	=	15.00
F-3	10.00	×	1.00	=	10.00	×	1.50	=	15.00
G-1	10.00	×	1.00	=	10.00	×	1.50	=	15.00
G-2	10.00	×	1.00	=	10.00	×	1.50	=	15.00
G-3	10.00	×	1.00	=	10.00	×	1.50	=	15.00
H-1	10.00	×	1.00	=	10.00	×	1.50	=	15.00
H-2	10.00	×	1.00	=	10.00	×	1.50	=	15.00
H-3	10.00	×	1.00	=	10.00	×	1.50	=	15.00
I-1	11.00	×	1.00	=	11.00	×	1.50	=	16.50
I-2	11.00	×	1.00	=	11.00	×	1.50	=	16.50
I-3	11.00	×	1.00	=	11.00	×	1.50	=	16.50
J-1	12.00	×	1.00	=	12.00	×	1.50	=	18.00
J-2	12.00	×	1.00	=	12.00	×	1.50	=	18.00
J-3	12.00	×	1.00	=	12.00	×	1.50	=	18.00
計	333.00				333.00				499.50